

- Elevators
- Restrooms
- Registration Desk
- Noninvasive Cardiology
- Cardiac Cath Lab Recovery
- Cardiac Cath Labs
- E P Lab

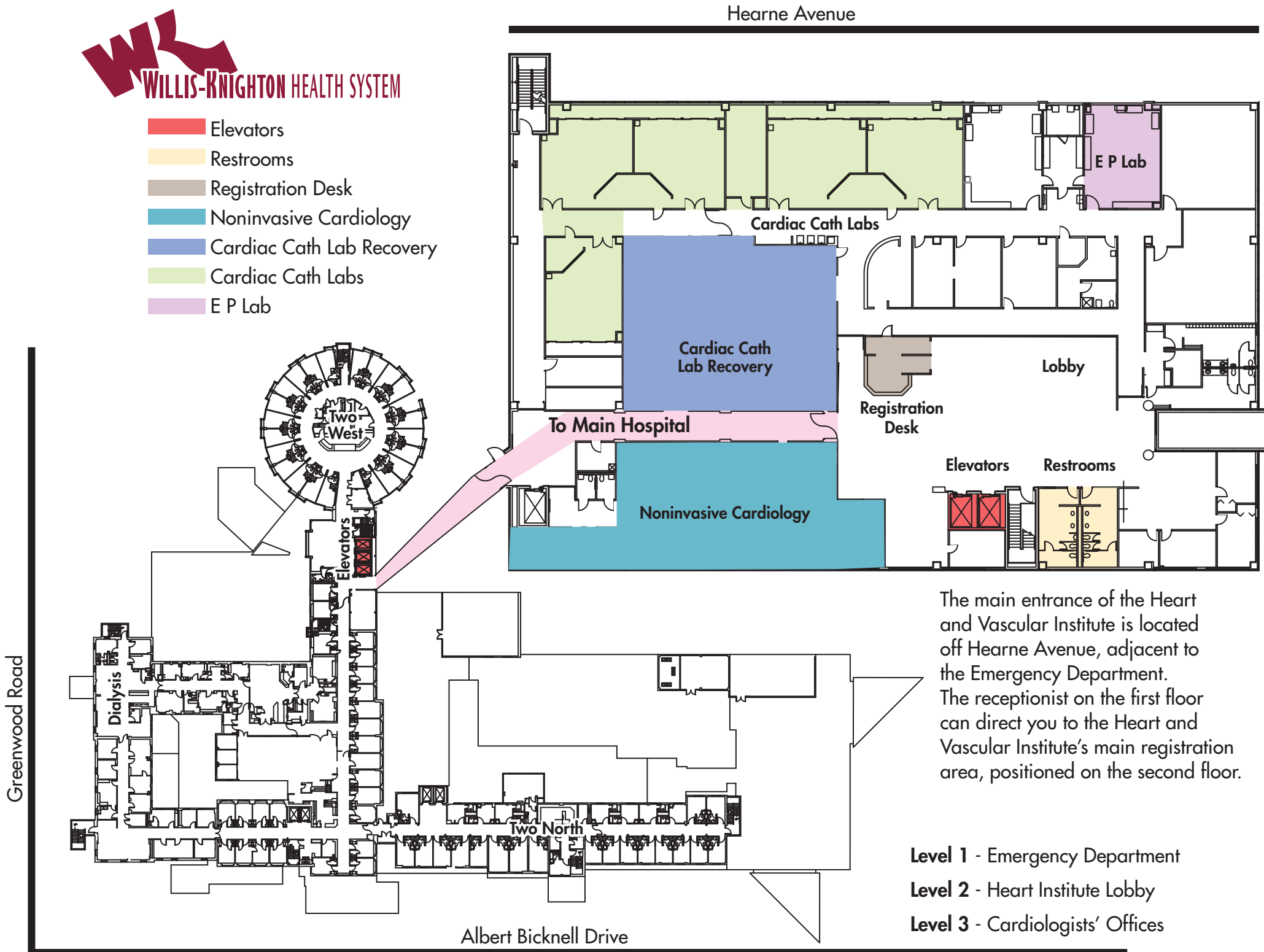

The main entrance of the Heart and Vascular Institute is located off Hearne Avenue, adjacent to the Emergency Department. The receptionist on the first floor can direct you to the Heart and Vascular Institute's main registration area, positioned on the second floor.

- Level 1** - Emergency Department
- Level 2** - Heart Institute Lobby
- Level 3** - Cardiologists' Offices